

PART MUST INSERT FULLY TO SURFACE A IN RECOMMENDED GRID
 .025 SQ.(4)
 [.64]

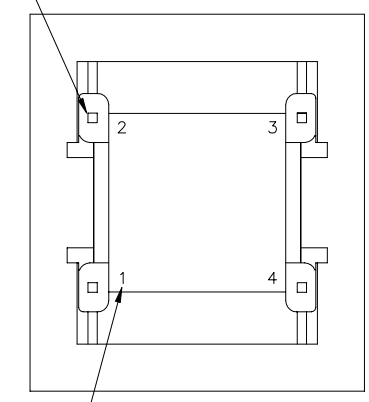

TERM. NO.'s FOR REF. ONLY

.110/.140
 [2.79/3.56]

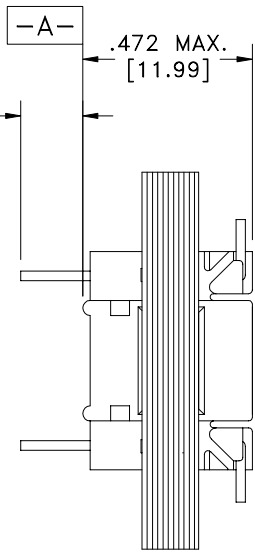

TAB LOCATES TERM. #1-2 SIDE

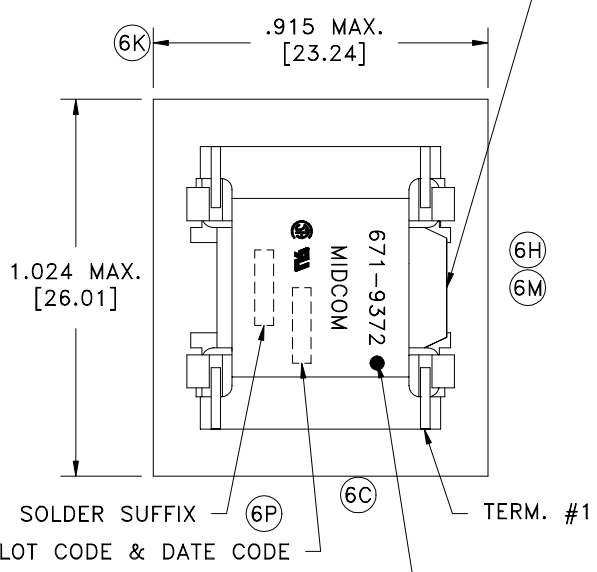

SOLDER SUFFIX (6P)
 LOT CODE & DATE CODE
 DOT LOCATES TERM. #1

(6K) NOTE: This product can be rotated 180° without affecting the pin-out or electrical performance.

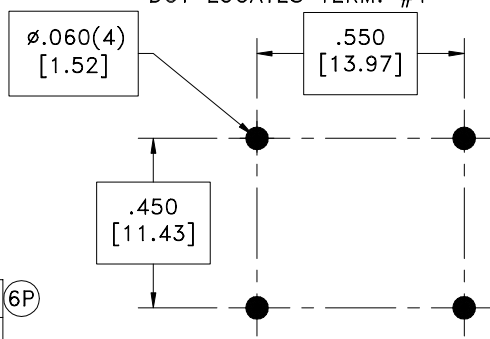
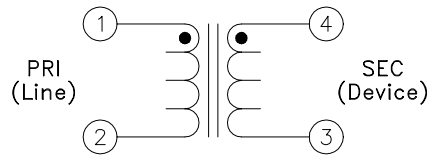

(6M) RECOMMENDED P.C. PATTERN, COMPONENT SIDE

SOLDER SUFFIX	CUSTOMER TERMINAL	RoHS	LEAD(Pb)-FREE (6P)
	Sn98%, Pb2%	No	No
LF3	Sn100%	Yes	Yes

(6M) ELECTRICAL SPECIFICATIONS @ 25°C unless otherwise noted:

IMPEDANCE: Designed to reflect 600 ohm on PRI with 530 ohm load on SEC.
 LONGITUDINAL BALANCE: 60dB min., 200 - 1000Hz; 40dB min., 1000 - 4000Hz; per FCC 68.310. 58dB min., greater than 63dB typ., 200 - 1000Hz; 53dB min., greater than 58dB typ., 1000 - 3000Hz; per IEEE-455, 1985/BELLCORE TR-TSY-000057, Sect. 6.5.
 D.C. RESISTANCE (@20°C): PRI, 43 ohms ±10%. SEC, 43 ohms ±10%.
 FREQUENCY RESPONSE: ±0.20dB, 200Hz - 4kHz.
 INSERTION LOSS: 1.0dB max., 1000Hz.
 DIELECTRIC RATING: 1000VAC, 1 minute tested by applying 1250VAC for 1 second between PRI-SEC. Meets or exceeds requirements of: CAN/CSA-C22.2 No.225 (M90); DOC's CS-03 (Issue 7); UL's UL1459, 2nd Ed. (1992); and FCC's Part 68 (58 FR 44907, Aug. 25, 1993).
 D.C. CURRENT: None.
 INDUCTANCE: 3H min., 200Hz, 1.0VAC, 1-2, Lp.
 RETURN LOSS: 25dB min., 200 - 4000Hz.
 TURNS RATIO: (1-2):(4-3) = 1:1, ±1%.

DETAILS SUBJECT TO CHANGE

(6H)

AGENCY NUMBER	
UL	E99406
CSA	LR61218

Midcom, Inc.
 Watertown, SD USA
 Toll Free: 800-643-2661
 Fax: 605-886-4486

Unless otherwise specified:
 Tolerances: Fractions: ±1/64
 Angles: ±1° Decimals: ±.005[.13]
 DRAWING TITLE

TRANSFORMER

REVISIONS: SEE SHEET 1

Midcom

DRAWING NO. **9372/-LF3** (6F) REV. 6Q
671-9372U/-LF3 5/05

SCALE --- SHEET 2 OF 5

This drawing is dual dimensioned.
 Dimensions in brackets are in millimeters.

DWG # 671-9372/U/-LF3